

KOŁA DO PASÓW ZĘBATYCH CALOWYCH

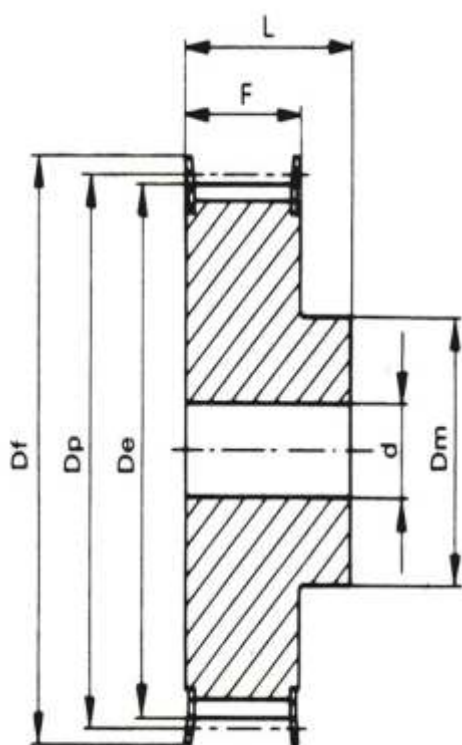

KOŁA DO PASÓW ZĘBATYCH CALOWYCH

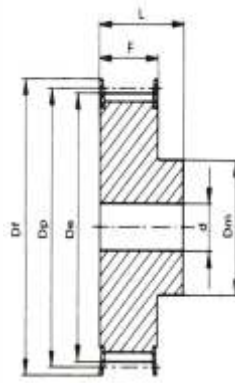

DLA SZEROKOŚCI PASA 200(2"=50.8MM)

Indeks	Ilość zębów z	Wykonanie	Materiał	Wymiary fi Dp	fi De	Wymiar koła fi Df	F	L	Dm	Technol. otwór fi d	kg
K H 300/14	14	2F	St	56.59	55.22	63	58.7	70	40	-	1.10
K H 300/15	15	2F	St	60.64	59.27	66	58.7	70	45	-	1.33
K H 300/16	16	2F	St	64.68	63.31	71	58.7	70	45	-	1.54
K H 300/17	17	2F	St	68.72	67.35	75	58.7	70	45	-	1.69
K H 300/18	18	2F	St	72.77	71.39	79	58.7	70	55	-	1.95
K H 300/19	19	2F	St	76.81	75.44	83	58.7	70	60	-	2.20
K H 300/20	20	2F	St	80.85	79.48	87	58.7	70	62	-	2.44
K H 300/21	21	2F	St	84.89	83.52	91	58.7	70	65	-	2.70
K H 300/22	22	2F	St	88.94	87.56	93	58.7	70	68	-	2.97
K H 300/23	23	2F	St	92.98	91.61	97	58.7	70	72	-	3.25
K H 300/24	24	2F	St	97.03	95.65	103	58.7	70	72	-	3.56
K H 300/25	25	2F	St	101.06	99.69	106	58.7	70	72	-	3.81
K H 300/26	26	2F	St	105.11	103.73	111	58.7	70	80	-	4.18
K H 300/27	27	2F	St	109.15	107.78	115	58.7	70	80	-	4.49
K H 300/28	28	2F	St	113.19	111.82	119	58.7	70	80	-	4.81
K H 300/29	29	2F	St	117.23	115.86	123	58.7	70	80	-	5.14
K H 300/30	30	2F	St	121.29	119.90	127	58.7	70	80	-	5.47
K H 300/32	32	2F	St	129.36	127.99	135	58.7	70	80	-	6.17
K H 300/33	33	2F	St	133.40	132.03	140	58.7	70	80	-	6.56
K H 300/34	34	2F	St	137.45	136.07	143	58.7	70	80	-	6.94
K H 300/35	35	2F	St	141.49	140.12	148	58.7	70	80	-	7.34
K H 300/36	36	2F	St	145.53	144.16	152	58.7	70	80	-	7.75
K H 300/38	38	2F	St	153.62	152.24	158	58.7	70	80	-	8.62
K H 300/40	40	2F	St	161.70	160.33	168	58.7	70	80	-	9.50
K H 300/44	44	4F	GG	177.87	176.50	184	58.7	70	80	18	-
K H 300/45	45	4F	GG	181.91	180.54	192	58.7	70	80	18	-
K H 300/48	48	4F	GG	194.04	192.67	200	58.7	75	90	24	-
K H 300/50	50	4	GG	202.13	200.75	-	58.7	75	90	24	-
K H 300/52	52	4	GG	210.21	208.84	-	58.7	75	90	24	-
K H 300/58	58	4	GG	234.47	233.09	-	58.7	75	90	24	-
K H 300/60	60	4	GG	242.55	241.18	-	58.7	75	100	24	-
K H 300/70	70	4	GG	282.98	281.61	-	58.7	75	100	28	-
K H 300/72	72	4	GG	291.06	289.69	-	58.7	75	120	28	-
K H 300/84	84	4	GG	339.57	338.20	-	58.7	75	120	28	-
K H 300/96	96	4	GG	388.08	386.71	-	58.7	75	120	28	-
K H 300/120	120	4	GG	485.10	483.73	-	58.7	75	120	28	-

KOŁA DO PASÓW ZĘBATYCH CALOWYCH

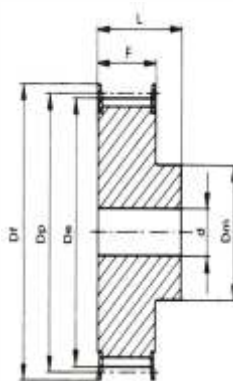

DLA SZEROKOŚCI PASA 300 (3"=76.2MM)

Indeks	Ilość zębów z	Wykonanie	Materiał	Wymiar fi Dp	fi De	Wymiar koła fi Df	F	L	Dm	Technol. otwór fi d	kg
K H 300/16	16	2F	St	64.68	63.31	71	85.7	100	45	-	2.16
K H 300/17	17	2F	St	68.72	67.35	75	85.7	100	45	-	2.43
K H 300/18	18	2F	St	72.77	71.39	79	85.7	100	55	-	2.80
K H 300/20	20	2F	St	80.85	79.48	87	85.7	100	62	-	3.50
K H 300/21	21	2F	St	84.89	83.52	91	85.7	100	65	-	3.87
K H 300/22	22	2F	St	88.94	87.56	93	85.7	100	68	-	4.26
K H 300/23	23	2F	St	92.98	91.61	97	85.7	100	72	-	4.68
K H 300/24	24	2F	St	97.03	95.65	103	85.7	100	72	-	5.08
K H 300/25	25	2F	St	101.06	99.69	106	85.7	100	72	-	5.45
K H 300/26	26	2F	St	105.11	103.73	111	85.7	100	80	-	6.01
K H 300/27	27	2F	St	109.15	107.78	115	85.7	100	80	-	6.45
K H 300/28	28	2F	St	113.19	111.82	119	85.7	100	80	-	6.91
K H 300/30	30	2F	St	121.29	119.90	127	85.7	100	80	-	7.90
K H 300/32	32	2F	St	129.36	127.99	135	85.7	100	80	-	8.92
K H 300/33	33	2F	St	133.40	132.03	140	85.7	100	80	-	9.46
K H 300/34	34	2F	St	137.45	136.07	143	85.7	100	80	-	10.04
K H 300/35	35	2F	St	141.49	140.12	148	85.7	100	80	-	10.62
K H 300/36	36	2F	St	145.53	144.16	152	85.7	100	80	-	11.24
K H 300/38	38	2F	St	153.62	152.24	158	85.7	100	80	-	12.44
K H 300/40	40	4F	St	161.70	160.33	168	85.7	100	80	-	13.80
K H 300/44	44	4F	GG	177.87	176.50	184	85.7	100	80	24	-
K H 300/48	48	4	GG	194.04	192.67	200	85.7	100	90	24	-
K H 300/50	50	4	GG	202.13	200.75	-	85.7	100	90	24	-
K H 300/58	58	4	GG	234.47	233.09	-	85.7	100	90	24	-
K H 300/60	60	4	GG	242.55	241.18	-	85.7	100	100	24	-
K H 300/72	72	4	GG	291.06	289.69	-	85.7	100	120	28	-
K H 300/84	84	4	GG	339.57	338.20	-	85.7	100	120	28	-
K H 300/96	96	4	GG	388.08	386.71	-	85.7	100	120	28	-
K H 300/120	120	4	GG	485.10	483.73	-	85.7	100	120	28	-

KOŁA DO PASÓW ZĘBATYCH CALOWYCH

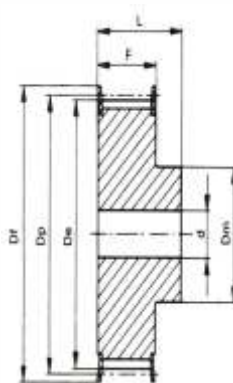

DLA SZERKOSCI PASA 400(4"=101.6MM)

Indeks	Ilość zębów z	Wykonanie	Wymiar fi Dp	fi de	Wymiar koa fi Df	F	L	Dm	Technol. otwór fi d	kg
K XH 400/18	18	2F	127.34	124.55	138	119	132	100	32	9.6
K XH 400/19	19	2F	134.41	131.62	146	119	132	100	32	10.8
K XH 400/20	20	2F	141.49	138.69	154	119	132	100	32	12.0
K XH 400/21	21	2F	148.56	145.77	160	119	132	110	32	13.3
K XH 400/22	22	2F	155.64	152.84	168	119	132	110	32	14.9
K XH 400/24	24	2F	169.79	166.99	183	119	132	120	32	17.9
K XH 400/25	25	2F	176.86	174.07	188	119	132	120	32	19.6
K XH 400/26	26	2F	183.93	181.14	198	119	132	120	32	21.2
K XH 400/27	27	2F	191.01	188.22	200	119	132	120	32	22.8
K XH 400/28	28	2F	198.09	195.29	211	119	132	150	32	24.7
K XH 400/30	30	2F	212.23	209.44	226	119	132	150	32	28.8
K XH 400/32	32	2F	226.38	223.59	240	119	132	150	32	32.7
K XH 400/34	34	2F	240.53	237.74	256	119	132	150	32	36.7

KOŁA DO PASÓW ZĘBATYCH CALOWYCH

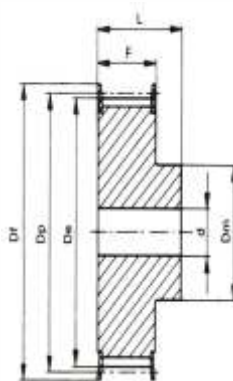

DLA SZEROKOŚCI PASA 300(3"=76.2MM)

Indeks	Ilość zębów z	Wykonanie	Wymiar fi Dp	fi De	Wymiar koła fi Df	F	L	Dm	Technol. otwór fi d	kg
K XH 300/18	18	2F	127.34	124.55	138	92	110	100	28	8.9
K XH 300/19	19	2F	134.41	131.62	146	92	110	100	28	9.2
K XH 300/20	20	2F	141.49	138.69	154	92	110	100	28	9.5
K XH 300/21	21	2F	148.56	145.77	160	92	110	110	28	10.8
K XH 300/22	22	2F	155.64	152.84	168	92	110	110	28	12.3
K XH 300/24	24	2F	169.79	166.99	183	92	110	120	28	14.2
K XH 300/25	25	2F	176.86	174.07	188	92	110	120	28	15.5
K XH 300/26	26	2F	183.93	181.14	198	92	110	120	28	16.7
K XH 300/27	27	2F	191.01	188.22	200	92	110	120	28	18.5
K XH 300/28	28	2F	198.09	195.29	211	92	110	120	28	20.3
K XH 300/30	30	2F	212.23	209.44	226	92	110	120	28	23.9
K XH 300/32	32	2F	226.38	223.59	240	92	110	120	28	26.6
K XH 300/34	34	2F	240.53	237.74	256	92	110	120	28	31.5

KOŁA DO PASÓW ZĘBATYCH CALOWYCH

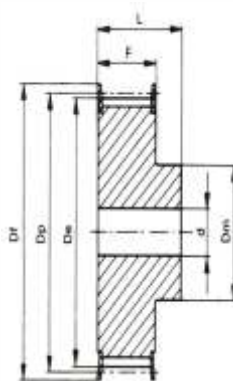

DLA PASA O SZERKOŚCI 100(1"=25.4MM)

Indeks	Ilość zębów z	Wykonanie	Materiał	Tuleja Taper Lock	Max fi otwór	Wymiar fi Dp	fi De	Wymiar koła fi Df	F	L	Dm	Di	R	kg
K T L L 100/18	18	16F	St	1108	28	54.57	53.81	60.0	31	22	-	38	9.0	0.20
K T L L 100/19	19	16F	St	1108	28	57.61	56.84	63.0	31	22	-	38	9.0	0.32
K T L L 100/20	20	16F	St	1108	28	60.64	59.88	66.0	31	22	-	45	9.0	0.41
K T L L 100/21	21	16F	St	1108	28	63.67	62.91	71.0	31	22	-	45	9.0	0.45
K T L L 100/22	22	16F	St	1108	28	66.70	65.94	75.0	31	22	-	48	9.0	0.47
K T L L 100/23	23	16F	St	1108	28	69.73	68.97	79.0	32	22	-	52	10.0	0.50
K T L L 100/24	24	16F	St	1108	28	72.77	72.00	79.0	32	22	-	52	10.0	0.64
K T L L 100/25	25	16F	St	1108	28	75.80	75.04	83.0	32	22	-	54	10.0	0.68
K T L L 100/26	26	16F	St	1108	28	78.83	78.07	87.0	32	22	-	60	10.0	0.70
K T L L 100/27	27	16F	St	1108	28	81.86	81.10	87.0	32	22	-	60	10.0	0.83
K T L L 100/28	28	16F	St	1108	28	84.89	84.13	91.0	32	22	-	65	10.0	0.85
K T L L 100/30	30	16F	St	1210	32	90.96	90.20	97.0	32	25	-	71	7.0	0.90
K T L L 100/32	32	16F	St	1210	35	97.02	96.26	103.0	32	25	-	75	7.0	1.05
K T L L 100/36	36	16F	St	1610	42	109.15	108.39	115.0	32	25	-	86	7.0	1.40
K T L L 100/40	40	16F	St	1610	42	121.28	120.51	127.0	32	25	-	96	7.0	1.65
K T L L 100/48	48	17F	St	1610	42	145.53	144.77	152.0	32	25	92	120	7.0	2.80
K T L L 100/60	60	19	St	1610	42	181.91	181.15	-	32	25	92	166	3.5	2.70
K T L L 100/72	72	22	GG	2012	50	218.30	217.53	-	32	32	106	202	-	-
K T L L 100/84	84	22	GG	2012	50	254.68	253.90	-	32	32	106	236	-	-
K T L L 100/96	96	22	GG	1012	50	291.06	290.30	-	32	32	106	270	-	-
K T L L 100/120	120	22	GG	2012	50	363.83	363.0	-	32	32	106	343	-	-

KOŁA DO PASÓW ZĘBATYCH CALOWYCH

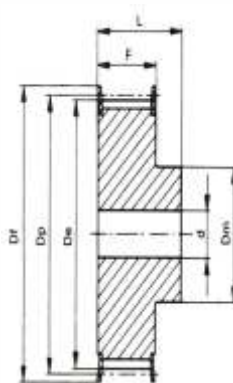

DLA PASA O SZEROKOŚCI 100(1"=25.4MM)

Indeks	Ilość zębów z	Wykonanie	Materiał	Tuleja Taper Lock	Max fi otwór	Wymiar fi Dp	fi De	Wymiar koła fi Df	F	L	Dm	Di	R	kg
K TL H 100/16	16	16F	St	1108	28	64.68	63.31	71.0	31	22	-	45.0	9.0	0.42
K TL H 100/18	18	16F	St	1210	32	72.77	71.39	79.0	31	25	-	52.0	6.0	0.49
K TL H 100/19	19	16F	St	1210	32	76.81	75.44	83.0	31	25	-	56.0	6.0	0.62
K TL H 100/20	20	16F	St	1210	32	80.85	79.48	87.0	31	25	-	60.0	6.0	0.73
K TL H 100/21	21	16F	St	1210	32	84.89	83.52	91.0	32	25	-	64.0	7.0	0.80
K TL H 100/22	22	16F	St	1210	32	88.94	87.56	93.0	32	25	-	67.0	7.0	0.94
K TL H 100/23	23	16F	St	1610	42	92.98	91.61	97.0	32	25	-	70.0	7.0	0.97
K TL H 100/24	24	16F	St	1610	42	97.02	95.65	103.0	32	25	-	73.5	7.0	1.05
K TL H 100/25	25	16F	St	1610	42	101.06	99.69	106.0	32	25	-	77.0	7.0	1.10
K TL H 100/26	26	16F	St	1610	42	105.11	103.73	111.0	32	25	-	82.0	7.0	1.20
K TL H 100/27	27	16F	St	1610	42	109.15	107.78	115.0	32	25	-	85.0	7.0	1.35
K TL H 100/28	28	16F	St	1610	42	113.19	111.82	119.0	32	25	-	90.5	7.0	1.50
K TL H 100/30	30	16F	St	1610	42	121.28	119.90	127.0	32	25	-	98.0	7.0	1.78
K TL H 100/32	32	17F	St	1610	42	129.36	127.99	135.0	32	25	90	106.0	7.0	2.05
K TL H 100/36	36	17F	St	1610	42	145.53	144.16	152.0	32	25	92	121.0	7.0	2.80
K TL H 100/40	40	17F	St	1610	42	161.70	160.33	168.0	32	25	92	138.0	7.0	3.65
K TL H 100/44	44	21F	St	2012	50	177.87	176.50	184.0	32	32	106	152.0	-	3.86
K TL H 100/48	48	21F	St	2012	50	194.04	192.67	200.0	32	32	106	169.0	-	4.20
K TL H 100/60	60	20	GG	2012	50	242.55	241.18	-	34	32	106	223.0	1.0	-
K TL H 100/72	72	20	GG	2012	50	291.06	289.69	-	34	32	106	270.0	1.0	-
K TL H 100/84	84	20	GG	2012	50	339.57	338.20	-	34	32	106	318.0	1.0	-
K TL H 100/96	96	14	GG	2517	60	388.08	386.71	-	34	45	119	366.0	5.5	-
K TL H 100/120	120	14	GG	2517	60	485.10	483.73	-	34	45	119	462.0	5.5	-

KOŁA DO PASÓW ZĘBATYCH CALOWYCH

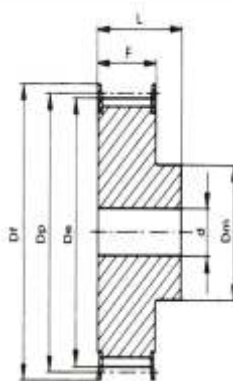

DLA SZERKOŚCI PASA 200(2"=50.8)

Indeks	Ilość zębów z	Wykonanie	Wymiar fi Dp	fi De	Wymiar koła fi Df	F	L	Dm	Technol. otwór fi d	kg
K XH 200/18	18	2F	127.34	124.55	138	65	80	100	24	6.0
K XH 200/19	19	2F	134.41	131.62	146	65	80	100	24	6.6
K XH 200/20	20	2F	141.49	138.69	154	65	80	100	24	7.3
K XH 200/21	21	2F	148.56	145.77	160	65	80	110	24	8.0
K XH 200/22	22	2F	155.64	152.84	168	65	80	110	24	8.8
K XH 200/24	24	2F	169.79	166.99	183	65	80	120	24	10.6
K XH 200/25	25	2F	176.86	174.07	188	65	80	120	24	11.5
K XH 200/26	26	2F	183.93	181.14	198	65	80	120	24	12.3
K XH 200/27	27	2F	191.01	188.22	200	65	80	120	24	13.6
K XH 200/28	28	2F	198.09	195.29	211	65	80	120	24	14.5
K XH 200/30	30	2F	212.23	209.44	226	65	80	120	24	16.2
K XH 200/32	32	2F	226.38	223.59	240	65	80	120	24	17.8
K XH 200/34	34	2F	240.53	237.74	256	65	80	120	24	18.9

KOŁA DO PASÓW ZĘBATYCH CALOWYCH

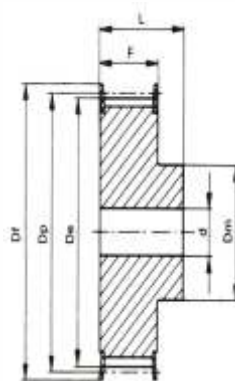

DLA SZEROKOŚCI PASA 150(1.5"=38.1)

Indeks	Ilość zębów z	Wykonanie	Materiał	Wymiar fi Dp	fi De	Wymiar koła fi Df	F	L	Dm	Technol. otwór fi d	kg
K H 100/14	14	2F	St	56.59	55.22	63	46.0	58	40	18	0.81
K H 100/15	15	2F	St	60.64	59.27	66	46.0	58	45	18	0.97
K H 100/16	16	2F	St	64.68	63.31	71	46.0	58	45	18	1.11
K H 100/17	17	2F	St	68.72	67.35	75	46.0	58	45	18	1.25
K H 100/18	18	2F	St	72.77	71.39	79	46.0	58	55	18	1.48
K H 100/19	19	2F	St	76.81	75.44	83	46.0	58	60	18	1.68
K H 100/20	20	2F	St	80.85	79.48	87	46.0	58	62	18	1.88
K H 100/21	21	2F	St	84.89	83.52	91	46.0	58	65	18	2.08
K H 100/22	22	2F	St	88.94	87.56	93	46.0	58	68	18	2.30
K H 100/23	23	2F	St	92.98	91.61	97	46.0	58	72	18	2.54
K H 100/24	24	2F	St	97.03	95.65	103	46.0	58	72	18	2.75
K H 100/25	25	2F	St	101.06	99.69	106	46.0	58	72	18	2.97
K H 100/26	26	2F	St	105.11	103.73	111	46.0	58	80	18	3.29
K H 100/27	27	2F	St	109.15	107.78	115	46.0	58	80	18	3.52
K H 100/28	28	2F	St	113.19	111.82	119	46.0	58	80	18	3.78
K H 100/29	29	2F	St	117.23	115.86	123	46.0	58	80	18	4.03
K H 100/30	30	2F	St	121.29	119.20	127	46.0	58	80	18	4.29
K H 100/32	32	2F	St	129.36	127.99	135	46.0	58	80	18	4.86
K H 100/33	33	2F	St	133.40	132.03	140	46.0	58	80	18	5.15
K H 100/34	34	2F	St	137.45	136.07	143	46.0	58	80	18	5.46
K H 100/35	35	2F	St	141.49	140.12	148	46.0	58	80	18	5.78
K H 100/36	36	2F	St	145.53	144.16	152	46.0	58	80	18	6.09
K H 100/38	38	2F	St	153.62	152.24	158	46.0	58	80	18	6.74
K H 100/40	40	2F	St	161.70	160.33	168	46.0	58	80	18	7.46
K H 100/44	44	4F	GG	177.87	176.50	184	46.0	58	80	18	-
K H 100/45	45	4F	GG	181.91	180.54	192	46.0	58	80	18	-
K H 100/48	48	4F	GG	194.04	192.67	200	46.0	65	90	18	-
K H 100/50	50	4F	GG	202.13	200.75	-	46.0	65	90	18	-
K H 100/52	52	4	GG	210.21	208.84	-	46.0	65	90	18	-
K H 100/58	58	4	GG	234.47	233.09	-	46.0	65	90	18	-
K H 100/60	60	4	GG	242.55	241.18	-	46.0	65	100	18	-
K H 100/70	70	4	GG	282.98	281.61	-	46.0	65	100	24	-
K H 100/72	72	4	GG	291.06	289.69	-	46.0	65	120	24	-
K H 100/84	84	4	GG	339.57	338.20	-	46.0	65	120	24	-
K H 100/96	96	4	GG	388.08	386.71	-	46.0	65	120	24	-
K H 100/120	120	4	GG	485.10	483.73	-	46.0	65	120	24	-

KOŁA DO PASÓW ZĘBATYCH CALOWYCH

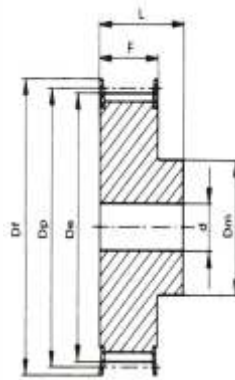

DLA SZEROKOŚCI PASA 100(1"=2,54MM)

Indeks	Ilość zębów z	Wykonanie	Materiał	Wymiar fi Dp	fi De	Wymiar koła fi Df	F	L	Dm	Technol. otwór fi d	kg
K H 100/14	14	2F	St	56.59	55.22	63	31.8	45	40	12	0.65
K H 100/15	15	2F	St	60.64	59.27	66	31.8	45	45	12	0.77
K H 100/16	16	2F	St	64.68	63.31	71	31.8	45	45	12	0.87
K H 100/17	17	2F	St	68.72	67.35	75	31.8	45	45	12	0.97
K H 100/18	18	2F	St	72.77	71.39	79	31.8	45	55	12	1.16
K H 100/19	19	2F	St	76.81	75.44	83	31.8	45	60	14	1.30
K H 100/20	20	2F	St	80.85	79.48	87	31.8	45	62	14	1.44
K H 100/21	21	2F	St	84.89	83.52	91	31.8	45	65	14	1.60
K H 100/22	22	2F	St	88.94	87.56	93	31.8	45	68	14	1.76
K H 100/23	23	2F	St	92.98	91.61	97	31.8	45	72	14	1.94
K H 100/24	24	2F	St	97.03	95.65	103	31.8	45	72	14	2.09
K H 100/25	25	2F	St	101.06	99.69	106	31.8	45	72	14	2.24
K H 100/26	26	2F	St	105.11	103.73	111	31.8	45	80	14	2.49
K H 100/27	27	2F	St	109.15	107.78	115	31.8	45	80	14	2.66
K H 100/28	28	2F	St	113.19	111.82	119	31.8	45	80	14	2.83
K H 100/30	30	2F	St	121.29	119.90	127	31.8	45	80	14	3.19
K H 100/32	32	2F	St	129.36	127.99	135	31.8	45	80	14	3.57
K H 100/33	33	2F	St	133.40	132.03	140	31.8	45	80	14	3.79
K H 100/34	34	2F	St	137.45	136.07	143	31.8	45	80	14	3.99
K H 100/35	35	2F	St	141.49	140.12	148	31.8	45	80	14	4.20
K H 100/36	36	2F	St	145.53	144.16	152	31.8	45	80	14	4.44
K H 100/38	38	2F	St	153.62	152.24	158	31.8	45	80	14	4.90
K H 100/40	40	4F	St	161.70	160.33	168	31.8	45	80	14	5.39
K H 100/44	44	4F	St	177.87	176.50	184	31.8	50	80	18	-
K H 100/45	45	4F	GG	181.91	180.54	192	31.8	50	80	18	-
K H 100/48	48	4F	GG	194.04	192.67	200	31.8	50	90	18	-
K H 100/50	50	4	GG	202.13	200.75	-	31.8	50	90	18	-
K H 100/52	52	4	GG	210.21	208.84	-	31.8	50	90	18	-
K H 100/58	58	4	GG	234.47	233.09	-	31.8	50	90	18	-
K H 100/60	60	4	GG	242.55	241.18	-	31.8	50	100	18	-
K H 100/70	70	4	GG	282.98	281.61	-	31.8	55	100	18	-
K H 100/72	72	4	GG	291.06	289.69	-	31.8	55	120	18	-
K H 100/84	84	4	GG	339.57	338.20	-	31.8	55	120	18	-
K H 100/96	96	4	GG	388.08	386.71	-	31.8	60	120	18	-
K H 100/120	120	4	GG	485.10	483.73	-	31.8	60	120	18	-

KOŁA DO PASÓW ZĘBATYCH CALOWYCH

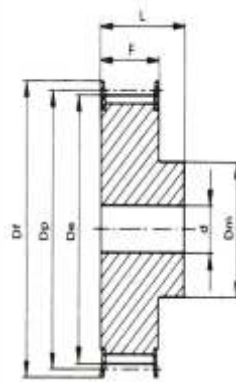

DLA SZEROKOŚCI PASA 100 (1"=25.4MM)

Indeks	Ilość zębów z	Wykonanie	Materiał	Wymiar fi Dp	fi De	Wymiar koła fi Df	F	L	Dm	Technol. otwór fi d	kg
K L 100/10	10	2F	St	30.32	29.56	36	31.8	45	20	8	0.17
K L 100/12	12	2F	St	36.38	35.62	42	31.8	45	24	8	0.26
K L 100/13	13	2F	St	39.41	38.65	44	31.8	45	28	8	0.32
K L 100/14	14	2F	St	42.44	41.68	48	31.8	45	28	10	0.35
K L 100/15	15	2F	St	45.48	44.72	51	31.8	45	34	10	0.43
K L 100/16	16	2F	St	48.51	47.75	54	31.8	45	36	10	0.50
K L 100/17	17	2F	St	51.54	50.78	57	31.8	45	36	10	0.56
K L 100/18	18	2F	St	54.57	53.81	60	31.8	45	40	10	0.64
K L 100/19	19	2F	St	57.61	56.84	63	31.8	45	40	10	0.70
K L 100/20	20	2F	St	60.64	59.88	66	31.8	45	40	10	0.77
K L 100/21	21	2F	St	63.67	62.91	71	31.8	45	45	10	0.88
K L 100/22	22	2F	St	66.70	65.94	75	31.8	45	45	12	0.95
K L 100/23	23	2F	St	69.73	68.97	79	31.8	45	45	12	1.11
K L 100/24	24	2F	St	72.77	72.00	79	31.8	45	45	12	1.18
K L 100/25	25	2F	St	75.80	75.04	83	31.8	45	58	12	1.30
K L 100/26	26	2F	St	78.83	78.07	87	31.8	45	58	12	1.40
K L 100/27	27	2F	St	81.86	81.10	87	31.8	45	58	12	1.47
K L 100/28	28	2F	St	84.98	84.13	91	31.8	45	58	12	1.58
K L 100/30	30	2F	St	90.96	90.20	97	31.8	45	70	12	1.78
K L 100/32	32	2F	St	97.03	96.26	103	31.8	45	70	12	2.11
K L 100/33	33	2F	St	100.05	99.29	106	31.8	45	70	12	2.23
K L 100/34	34	2F	St	103.08	102.32	111	31.8	45	70	12	2.39
K L 100/35	35	2F	St	106.12	105.35	111	31.8	45	70	12	2.45
K L 100/36	36	2F	St	109.15	108.39	115	31.8	45	70	12	2.59
K L 100/40	40	2F	St	121.29	120.51	127	31.8	45	70	12	3.13
K L 100/42	42	2F	St	127.34	126.58	135	31.8	45	70	12	3.43
K L 100/44	44	2F	St	133.40	132.64	140	31.8	45	70	12	3.72
K L 100/45	45	2F	St	136.44	135.67	143	31.8	45	70	12	3.89
K L 100/48	48	2F	St	145.53	144.77	152	31.8	45	70	12	4.38
K L 100/50	50	4	GG	151.60	150.83	-	31.8	45	70	14	-
K L 100/52	52	4	GG	157.66	156.90	-	31.8	45	70	14	-
K L 100/56	56	4	GG	169.79	169.02	-	31.8	45	70	14	-
K L 100/57	57	4	GG	172.82	172.06	-	31.8	45	70	14	-
K L 100/60	60	4	GG	181.91	181.15	-	31.8	45	75	14	-
K L 100/72	72	4	GG	218.29	217.53	-	31.8	45	75	14	-
K L 100/84	84	4	GG	254.68	253.92	-	31.8	45	75	14	-
K L 100/96	96	4	GG	291.06	290.30	-	31.8	45	75	14	-

KOŁA DO PASÓW ZĘBATYCH CALOWYCH

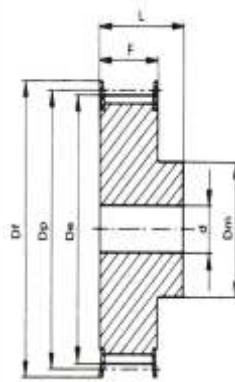

DLA PASA O SZEROKOŚCI PASA075 (3/4"=19.05)

Indeks	Ilość zębów z	Wykonanie	Materiał	Wymiar fi Dp	fi De	Wymiar koła fi Df	F	L	Dm	Technol. otwór fi d	kg
K L 075/10	10	2F	St	30.32	29.56	36	25.4	38	20	8	0.14
K L 075/12	12	2F	St	36.38	35.62	42	25.4	38	24	8	0.22
K L 075/13	13	2F	St	39.41	38.65	44	25.4	38	28	8	0.26
K L 075/14	14	2F	St	42.44	41.68	48	25.4	38	28	8	0.30
K L 075/15	15	2F	St	45.48	44.72	51	25.4	38	34	8	0.37
K L 075/16	16	2F	St	48.51	47.75	54	25.4	38	36	8	0.43
K L 075/17	17	2F	St	51.54	50.78	57	25.4	38	36	10	0.46
K L 075/18	18	2F	St	54.57	53.81	60	25.4	38	40	10	0.54
K L 075/19	19	2F	St	57.61	56.84	63	25.4	38	40	10	0.58
K L 075/20	20	2F	St	60.64	59.98	66	25.4	38	40	10	0.64
K L 075/21	21	2F	St	63.67	62.91	71	25.4	38	45	10	0.71
K L 075/22	22	2F	St	66.70	65.94	75	25.4	38	45	10	0.79
K L 075/23	23	2F	St	69.73	68.97	79	25.4	38	55	10	0.94
K L 075/24	24	2F	St	72.77	72.00	79	25.4	38	55	10	1.00
K L 075/25	25	2F	St	75.80	75.04	83	25.4	38	58	10	1.10
K L 075/26	26	2F	St	78.83	78.07	87	25.4	38	58	12	1.16
K L 075/27	27	2F	St	81.86	81.10	87	25.4	38	58	12	1.22
K L 075/28	28	2F	St	84.89	84.13	91	25.4	38	58	12	1.30
K L 075/30	30	2F	St	90.96	90.20	97	25.4	38	70	12	1.47
K L 075/32	32	2F	St	97.03	96.26	103	25.4	38	70	12	1.75
K L 075/33	33	2F	St	100.05	99.29	106	25.4	38	70	12	1.85
K L 075/34	34	2F	St	103.08	102.32	111	25.4	38	70	12	1.93
K L 075/35	35	2F	St	106.12	105.35	111	25.4	38	70	12	2.03
K L 075/36	36	2F	St	109.15	108.39	115	25.4	38	70	12	2.14
K L 075/40	40	2F	St	121.29	120.51	127	25.4	38	70	12	2.56
K L 075/40	42	2F	St	127.34	126.58	135	25.4	38	70	12	2.81
K L 075/44	44	2F	St	133.40	132.64	140	25.4	38	70	12	3.02
K L 075/45	45	2F	St	136.44	135.67	143	25.4	38	70	12	3.16
K L 075/48	48	2F	St	145.53	144.77	152	25.4	38	70	12	3.57
K L 075/50	50	4	GG	151.60	150.83	-	25.4	38	70	14	-
K L 075/52	52	4	GG	157.66	156.90	-	25.4	38	70	14	-
K L 075/56	56	4	GG	169.79	169.02	-	25.4	38	70	14	-
K L 075/57	57	4	GG	172.82	172.06	-	25.4	38	70	14	-
K L 075/60	60	4	GG	181.91	181.15	-	25.4	45	75	14	-
K L 075/72	72	4	GG	218.29	217.53	-	25.4	45	75	14	-
K L 075/84	84	4	GG	254.68	253.92	-	25.4	45	75	14	-
K L 075/96	96	4	GG	291.06	290.30	-	25.4	45	75	14	-

KOŁA DO PASÓW ZĘBATYCH CALOWYCH

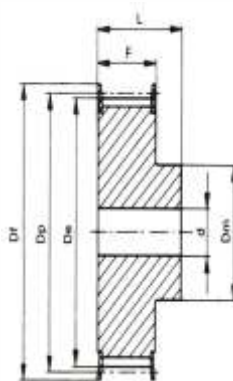

DLA SZEROKOŚCI PASA 050 (1/2"=12.7MM)

Indeks	Ilość zębów z	Wykonanie	Materiał	Wymiar fi Dp	fi De	Wymiar koła fi Df	F	L	Dm	Technol. otwór fi d	kg
K L 050/10	10	2F	St	30.32	29.56	36	19	28	20	8	0.11
K L 050/12	12	2F	St	36.38	35.62	42	19	30	24	8	0.17
K L 050/13	13	2F	St	39.41	38.65	44	19	30	28	8	0.21
K L 050/14	14	2F	St	42.44	41.68	48	19	30	28	8	0.24
K L 050/15	15	2F	St	45.48	44.72	51	19	30	34	8	0.29
K L 050/16	16	2F	St	48.51	47.75	54	19	32	36	8	0.33
K L 050/17	17	2F	St	51.54	50.78	57	19	32	36	10	0.38
K L 050/18	18	2F	St	54.57	53.81	60	19	32	40	10	0.44
K L 050/19	19	2F	St	57.61	56.84	63	19	32	40	10	0.47
K L 050/20	20	2F	St	60.64	59.88	66	19	32	40	10	0.51
K L 050/21	21	2F	St	63.67	62.91	71	19	32	45	10	0.60
K L 050/22	22	2F	St	66.70	65.94	75	19	32	45	10	0.64
K L 050/23	23	2F	St	69.73	68.97	79	19	32	55	10	0.78
K L 050/24	24	2F	St	72.77	72.00	79	19	32	55	10	0.81
K L 050/25	25	2F	St	75.80	75.04	83	19	32	58	10	0.89
K L 050/26	26	2F	St	78.83	78.07	87	19	32	58	12	0.94
K L 050/27	27	2F	St	81.86	81.10	87	19	32	58	12	0.99
K L 050/28	28	2F	St	84.89	84.13	91	19	32	58	12	1.04
K L 050/30	30	2F	St	90.96	90.20	97	19	32	70	12	1.17
K L 050/32	32	2F	St	97.03	96.26	103	19	32	70	12	1.41
K L 050/33	33	2F	St	100.05	99.29	106	19	32	70	12	1.49
K L 050/34	34	2F	St	103.08	102.32	111	19	32	70	12	1.62
K L 050/35	35	2F	St	106.12	105.35	111	19	32	70	12	1.70
K L 050/36	36	2F	St	109.15	108.39	115	19	32	70	12	2.03
K L 050/40	40	2F	St	121.29	120.51	127	19	32	70	12	2.21
K L 050/42	42	2F	St	127.34	126.58	135	19	32	70	12	2.38
K L 050/44	44	2F	St	133.40	132.64	140	19	32	70	12	2.48
K L 050/45	45	2F	St	136.44	135.67	143	19	32	70	12	2.78
K L 050/48	48	2F	St	145.53	144.77	152	19	32	70	12	-
K L 050/50	50	4	GG	151.60	150.83	-	19	32	70	14	-
K L 050/52	52	4	GG	157.66	156.90	-	19	32	70	14	-
K L 050/56	56	4	GG	169.79	169.02	-	19	32	70	14	-
K L 050/57	57	4	GG	172.82	172.06	-	19	32	70	14	-
K L 050/60	60	4	GG	181.91	181.15	-	19	42	75	14	-
K L 050/72	72	4	GG	218.29	217.53	-	19	42	75	14	-
K L 050/84	84	4	GG	254.68	253.92	-	19	42	75	14	-
K L 050/96	96	4	GG	291.06	290.30	-	19	42	75	14	-

KOŁA DO PASÓW ZĘBATYCH CALOWYCH

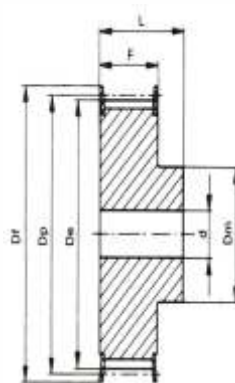

DLA SZEROKOŚCI PASA 037(3/8"=9.53)

Indeks	Ilość zębów Z	Wykonanie	Wymiar fi	fi De	Wymiar koła fi Df	F	L	Dm	Technol. otwór fi d	kg
K XL 037 /10	10	2F	16.17	15.66	23	14.3	20	10	-	0.01
K XL 037 /11	11	2F	17.79	17.28	23	14.3	20	10	-	0.01
K XL 037 /12	12	2F	19.40	18.90	25	14.3	20	10	-	0.01
K XL 037 /13	13	2F	21.02	20.51	25	14.3	20	10	-	0.01
K XL 037 /14	14	2F	22.64	23.13	28	14.3	20	16	-	0.02
K XL 037 /15	15	2F	24.25	23.75	28	14.3	20	16	-	0.02
K XL 037 /16	16	2F	25.87	25.36	32	14.3	20	16	-	0.03
K XL 037 /17	17	2F	27.49	26.98	32	14.3	20	20	-	0.03
K XL 037 /18	18	2F	29.11	28.60	36	14.3	20	20	-	0.04
K XL 037 /19	19	2F	30.72	30.21	36	14.3	20	20	-	0.04
K XL 037 /20	20	2F	32.34	31.83	38	14.3	20	25	-	0.05
K XL 037 /21	21	2F	33.96	33.45	38	14.3	20	25	-	0.05
K XL 037 /22	22	2F	35.57	35.07	42	14.3	20	25	-	0.06
K XL 037 /24	24	2F	38.81	38.30	44	14.3	20	30	-	0.06
K XL 037 /26	26	2F	42.04	41.53	48	14.3	20	30	8	0.09
K XL 037 /27	27	2F	43.66	43.15	51	14.3	20	34	8	0.09
K XL 037 /28	28	2F	45.28	44.77	54	14.3	20	34	8	0.10
K XL 037 /30	30	2F	48.51	48.00	57	14.3	25	38	8	0.12
K XL 037 /32	32	2F	51.74	51.24	60	14.3	25	38	8	0.12
K XL 037 /34	34	2F	54.98	54.47	63	14.3	25	38	8	0.13
K XL 037 /35	35	2F	56.60	56.09	-	14.3	25	38	8	0.14
K XL 037 /36	36	2	58.21	57.70	-	14.3	25	45	8	0.14
K XL 037 /38	38	2	61.45	60.94	-	14.3	25	45	8	0.15
K XL 037 /40	40	2	64.68	64.17	-	14.3	25	45	8	0.16
K XL 037 /42	42	2	67.91	67.41	-	14.3	25	45	8	0.18
K XL 037 /44	44	2	71.15	70.64	-	14.3	25	45	8	0.19
K XL 037 /48	48	2	77.62	77.11	-	14.3	25	45	10	0.19
K XL 037 /52	52	2	84.08	83.57	-	14.3	25	45	10	0.19
K XL 037 /60	60	2	97.02	96.51	-	14.3	25	45	10	0.22
K XL 037 /72	72		116.42	115.92	-	14.3	25	45	10	0.26

KOŁA DO PASÓW ZĘBATYCH CALOWYCH

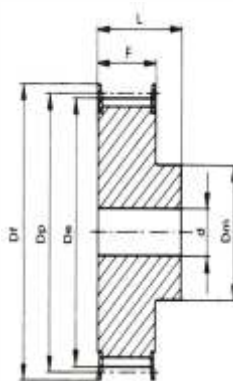

DLA PASA O SZEROKOŚCI 50MM

Indeks	Ilość zębów z	Wykonanie	Wymiar fi	fi De	Wymiar koła fi Df	F	L	Dm	Technol. otwór fi d	kg
K 66 AT 10/18	18	2F	52.29	55.45	60	56	66	40	10	0.42
K 66 AT 10/19	19	2F	60.48	58.65	66	56	66	44	10	0.47
K 66 AT 10/20	20	2F	63.66	61.80	66	56	66	46	12	0.52
K 66 AT 10/22	22	2F	70.03	68.20	75	56	66	52	12	0.57
K 66 AT 10/24	24	2F	76.39	74.55	83	56	66	58	12	0.74
K 66 AT 10/25	25	2F	79.58	77.75	83	56	66	60	12	0.77
K 66 AT 10/26	26	2F	82.76	80.90	87	56	66	60	12	0.82
K 66 AT 10/27	27	2F	85.95	84.05	91	56	66	60	12	0.95
K 66 AT 10/28	28	2F	89.13	87.25	93	56	66	60	12	0.96
K 66 AT 10/30	30	2F	95.49	93.65	97	56	66	60	12	1.17
K 66 AT 10/32	32	2F	101.86	100.00	106	56	66	65	12	1.30
K 66 AT 10/36	36	2F	114.59	112.75	119	56	66	70	16	1.64
K 66 AT 10/40	40	2F	127.32	125.45	131	56	66	80	16	2.00
K 66 AT 10/44	44	2	140.06	138.20	-	56	66	85	16	2.36
K 66 AT 10/48	48	2	152.78	150.95	-	56	66	95	16	2.83
K 66 AT 10/60	60	2	190.98	189.15	-	56	66	110	16	4.37

KOŁA DO PASÓW ZĘBATYCH CALOWYCH

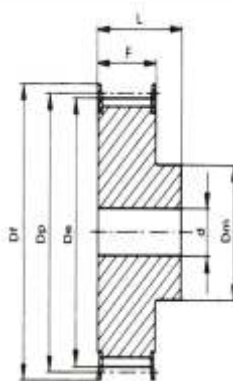

DLA PASA O SZEROKOŚCI 32MM

Indeks	Ilość zębów z	Wykonanie	Wymiar fi	fi De	Wymiar koła fi Df	F	L	Dm	Technol. otwór fi d	kg
K 47 AT 10/18	18	2F	57.29	55.45	60	37	47	40	10	0.25
K 47 AT 10/19	19	2F	60.48	58.65	66	37	47	44	10	0.29
K 47 AT 10/20	20	2F	63.66	61.80	66	37	47	46	12	0.32
K 47 AT 10/22	22	2F	70.03	68.20	75	37	47	52	12	0.39
K 47 AT 10/24	24	2F	76.39	74.55	83	37	47	58	12	0.47
K 47 AT 10/25	25	2F	79.58	77.75	83	37	47	60	12	0.53
K 47 AT 10/26	26	2F	82.76	80.90	87	37	47	60	12	0.56
K 47 AT 10/27	27	2F	85.95	84.05	91	37	47	60	12	0.60
K 47 AT 10/28	28	2F	89.13	87.25	93	37	47	60	12	0.64
K 47 AT 10/30	30	2F	95.49	93.65	97	37	47	60	12	0.74
K 47 AT 10/32	32	2F	101.86	100.00	106	37	47	65	12	0.84
K 47 AT 10/36	36	2F	114.59	112.75	119	37	47	70	16	1.06
K 47 AT 10/40	40	2F	127.32	125.45	131	37	47	80	16	1.32
K 47 AT 10/44	44	2	140.06	138.20	-	37	47	88	16	1.62
K 47 AT 10/48	48	2	152.78	150.95	-	37	47	95	16	1.93
K 47 AT 10/60	60	2	190.98	189.15	-	37	47	110	16	3.00

KOŁA DO PASÓW ZĘBATYCH CALOWYCH

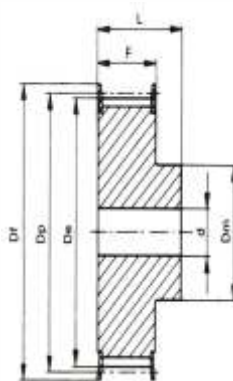

DLA SZEROKOŚCI PASA 075 (3/4"=19.05MM)

Indeks	Ilość zębów z	Wykonanie	Materiał	Wymiar fi Dp	fi De	Wymiar koła fi Df	F	L	Dm	Technol. otwór fi d	kg
K H 075/14	14	2F	St	56.59	55.22	63	26.4	40	40	11	0.58
K H 075/15	15	2F	St	60.64	59.27	66	26.4	40	45	11	0.69
K H 075/16	16	2F	St	64.68	63.31	71	26.4	40	45	11	0.77
K H 075/17	17	2F	St	68.72	67.35	75	26.4	40	45	11	0.84
K H 075/18	18	2F	St	72.77	71.39	79	26.4	40	55	11	1.01
K H 075/20	20	2F	St	80.85	79.48	87	26.4	40	62	11	1.27
K H 075/21	21	2F	St	84.89	83.52	91	26.4	40	65	11	1.41
K H 075/22	22	2F	St	88.94	87.56	93	26.4	40	68	11	1.55
K H 075/23	23	2F	St	92.98	91.61	97	26.4	40	72	11	1.71
K H 075/24	24	2F	St	97.03	95.65	103	26.4	40	72	11	1.83
K H 075/25	25	2F	St	101.06	99.69	106	26.4	40	72	11	1.96
K H 075/26	26	2F	St	105.11	103.73	111	26.4	40	80	11	2.19
K H 075/27	27	2F	St	109.15	107.78	115	26.4	40	80	11	2.32
K H 075/28	28	2F	St	113.19	111.82	119	26.4	40	80	11	2.47
K H 075/30	30	2F	St	121.29	119.90	127	26.4	40	80	11	2.76
K H 075/32	32	2F	St	129.36	127.99	135	26.4	40	80	11	3.08
K H 075/33	33	2F	St	133.40	132.03	140	26.4	40	80	11	3.25
K H 075/34	34	2F	St	137.45	136.07	143	26.4	40	80	11	3.42
K H 075/35	35	2F	St	141.49	140.12	148	26.4	40	80	11	3.61
K H 075/36	36	2F	St	145.53	144.16	152	26.4	40	80	11	3.79
K H 075/38	38	2F	St	153.62	152.24	158	26.4	40	80	11	4.16
K H 075/40	40	2F	St	161.70	160.33	168	26.4	40	80	11	4.58
K H 075/44	44	4F	GG	177.87	176.50	184	26.4	40	80	14	-
K H 075/48	48	4F	GG	194.04	192.67	200	26.4	45	90	14	-
K H 075/50	50	4	GG	202.13	200.75	-	26.4	45	90	14	-



65-772 Zielona Góra, ul. Dekoracyjna 1

tel. 68 324 44 68

tel./fax 68 327 23 57

e-mail: handlowiec@pipindustry.pl

sprzedaz@pipindustry.pl

www.pipindustry.pl